

T240 EMERGENCY TOUCH PAD (EXPLODED DIAGRAM)

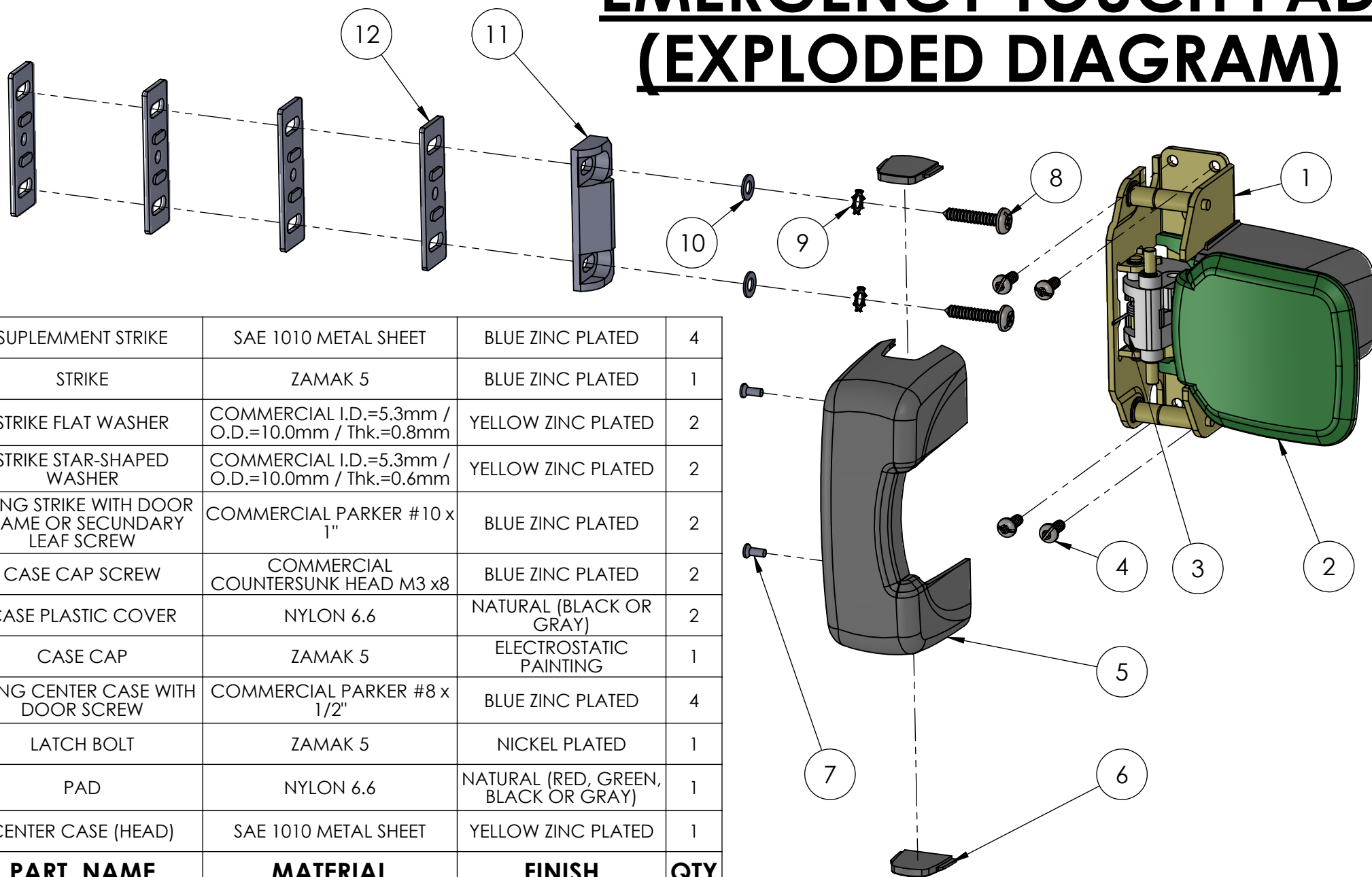

12	SUPPLEMENT STRIKE	SAE 1010 METAL SHEET	BLUE ZINC PLATED	4
11	STRIKE	ZAMAK 5	BLUE ZINC PLATED	1
10	STRIKE FLAT WASHER	COMMERCIAL I.D.=5.3mm / O.D.=10.0mm / Thk.=0.8mm	YELLOW ZINC PLATED	2
9	STRIKE STAR-SHAPED WASHER	COMMERCIAL I.D.=5.3mm / O.D.=10.0mm / Thk.=0.6mm	YELLOW ZINC PLATED	2
8	FIXING STRIKE WITH DOOR FRAME OR SECONDARY LEAF SCREW	COMMERCIAL PARKER #10 x 1"	BLUE ZINC PLATED	2
7	CASE CAP SCREW	COMMERCIAL COUNTERSUNK HEAD M3 x8	BLUE ZINC PLATED	2
6	CASE PLASTIC COVER	NYLON 6.6	NATURAL (BLACK OR GRAY)	2
5	CASE CAP	ZAMAK 5	ELECTROSTATIC PAINTING	1
4	FIXING CENTER CASE WITH DOOR SCREW	COMMERCIAL PARKER #8 x 1/2"	BLUE ZINC PLATED	4
3	LATCH BOLT	ZAMAK 5	NICKEL PLATED	1
2	PAD	NYLON 6.6	NATURAL (RED, GREEN, BLACK OR GRAY)	1
1	CENTER CASE (HEAD)	SAE 1010 METAL SHEET	YELLOW ZINC PLATED	1
No.	PART. NAME	MATERIAL	FINISH	QTY

BILL OF MATERIAL (BOM)

EXP-13-T240